

PRESSKIT

Fire fighting lobby pressurisation equipment in accordance with DM 30/11/1983 and with European standard EN 12101-6

The PRESSKIT equipment is comprised of one or more fans. In the case of fire they are activated to exert an overpressure of 50Pa in safe zones and to prevent the entry of smoke in escape routes for the evacuation of people.



Certified: NR331151



Common characteristics:

- Self-regulation of pressure throughout the lobby.
- Brushless 24Vdc E.C. fans with a maximum flow rate of 2100m³/H.
- An overpressure of 50Pa is maintained in the lobby.

Equipment control:

- S models: Simplified regulation of the ventilation unit via a pressure sensor with a built-in PID signal adjuster.
- P models: PLC control with multiple inputs, outputs, alarms and fan regulation via PID signal.
- Delay in equipment connection depending on the fire door status.
- Power supply panel with autonomy of more than 2 hours through 18Ah batteries.
- Ease in connecting equipment.
- Fast configuration and adjustment of all the parameters via LCD display and keyboard.
- MANUAL system activation button.
- Viewing of pressure in safe zone and equipment status in real time.

PRESSURISATION FAN

- Brushless 24VDC fan, 0-10V analogue control input.
- Maximum flow rate 2100m³/h.
- Mural fan for conduits with a diameter of 310mm.
- ROTOR-MOTOR air direction.
- Useful life in continuous operation of more than 20,000 hours.
- Rotor made of painted sheet steel.
- Protective anti-contact grille.

- Possibility of controlling 2 fans with a single panel and power source. (PRESSKIT TWIN).
- Regulation through a single control panel of 1 or 2 ventilation units.
- Key lock.

CONTROL PANEL

- System control panel through small PLC that is easy to install. Power supply 230VAC.
- Digital input for detecting open door.
- Digital outputs indicating fire alarm activated, through visual and acoustic indicator light that flashes with configurable times.
- Configurable connection delay times in the event of detecting a fire alarm and fire doors open.
- Configuration of all the PID output parameters.
- Manual system activation button.
- Viewing of pressure in Pa in real time, indication of equipment status STANDBY/ PRESSURISING.

Control panel characteristics

Total voltage (V): 1x230	Total current (A): 0.3
Output Voltage 1 (V): 19.7-28VDC	Output Voltage 2 (V): 19.7-28VDC
Max. current Output 1 (A): 6	Max. current Output 2 (A): 7
Protection (IP): 44	Operating temperature (°C): -25 to +60
Weight (Kg): 30.5	

PRESSURE SENSOR WITH DISPLAY

(BUILT INTO CONTROL PANEL)

- 0-100 Pa preconfigured differential pressure sensor.
- 0..10V analogue output.
- LCD display.
- Calibrated high precision analogue sensor.



+50 Pa

Order code

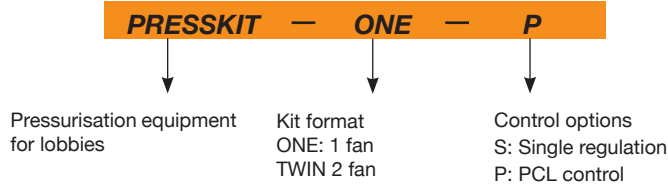

Technical characteristics

Model	Maximum flow rate (m3/h)	Maximum pressure (Pa)	Speed (rpm)	Irradiated LpA 3m dB(A)	Total voltage (V)	Total current (A)	Total power (w)	Weight (kg)	Protection (IP)	Operating temperature: (°C)	Nominal diameter of conduit (mm)
PRESSKIT ONE	2100	180	1800	65	24VDC	4.8	115	6.8	42	-25 to +60	310
PRESSKIT TWIN	4100	180	1800	68	24VDC	9.6	230	13.6	42	-25 to +60	310

Dimensions mm

PRESSURISATION FAN

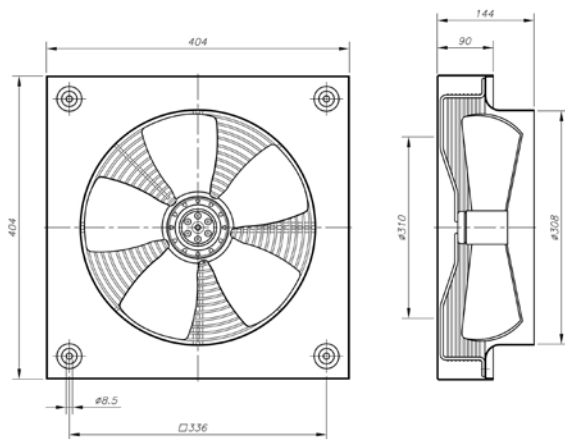

CONTROL PANEL

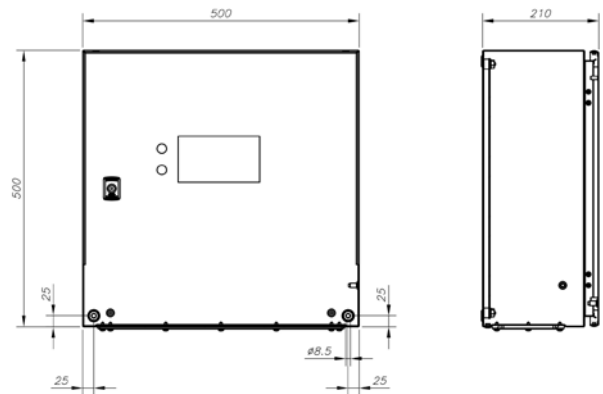

Kit characteristics

Component	PRESSKIT	
	ONE	TWIN
Regulation by means of pressure sensor	YES	YES
Regulation of several fans	-	YES*
Relay outputs to indicate the equipment is activated	YES	YES
Door sensor inputs	YES	YES

* PRESSKIT TWIN regulates two fans simultaneously with a single pressure sensor for large lobbies/pressurised areas. The regulation of each fan is not separate, they have the same PID set point depending on the signal received from the sensor.

Configurations

Component	PRESSKIT	
	ONE	TWIN
E.C. FAN BRUSHLESS 24Vdc	1 unit	2 units
CONTROL PANEL	1 unit	1 unit
PRESSURE SENSOR (BUILT INTO CONTROL PANEL)	1 unit	1 unit

Accessories

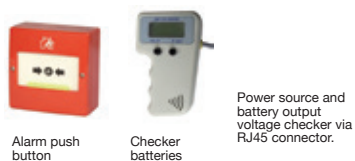

Alarm push button

Checker batteries

Power source and battery output voltage checker via RJ45 connector.